

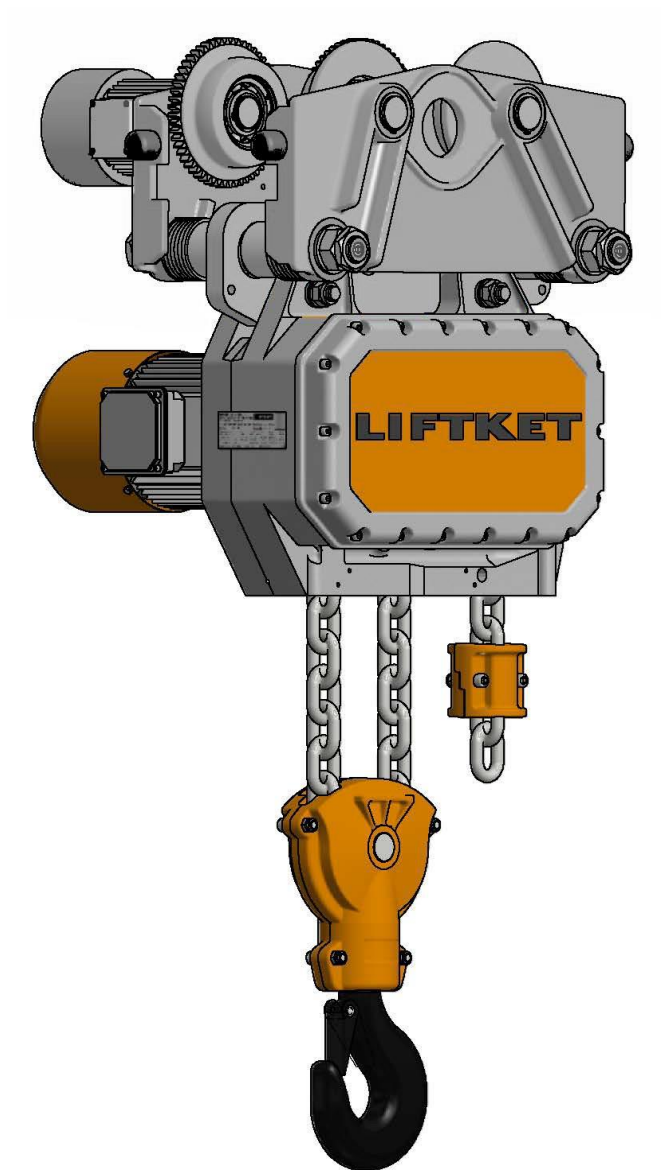

Spare parts list

Electric chain hoist | Type 13 / Type 15



LIFTKET Hoffmann GmbH

Dresdener Straße 66-68
04808 Wurzen / Germany

 +49-3425-89 24-0

 +49-3425-89 24-99

 sales@liftket.de

 www.liftket.de

Ho 03/2020 englisch

Overview

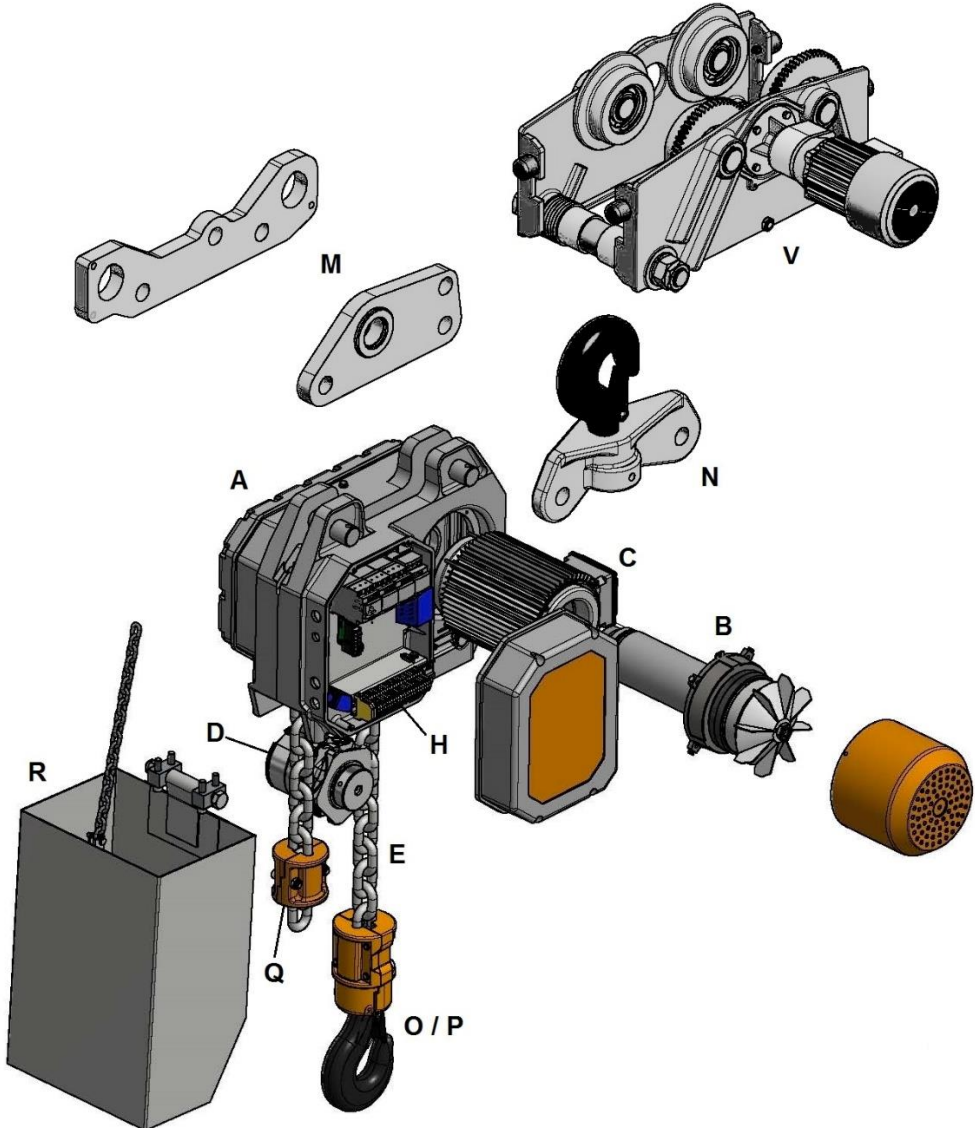

A	Hoist body	4
B	Brake - clutch	5
C	Stator	6
D	Sprocket wheel	7
E	Chain	8
H	Low voltage control	9
J	Electric limit switch	14
M	Suspension eye	15
N	Hook suspension	16
O	Hook block	17
P	Hook tackle	18
Q	Lift limiter	19
R	Chain box	20
V	Electric trolley	21
W	Tandem trolley	23

A Hoist body

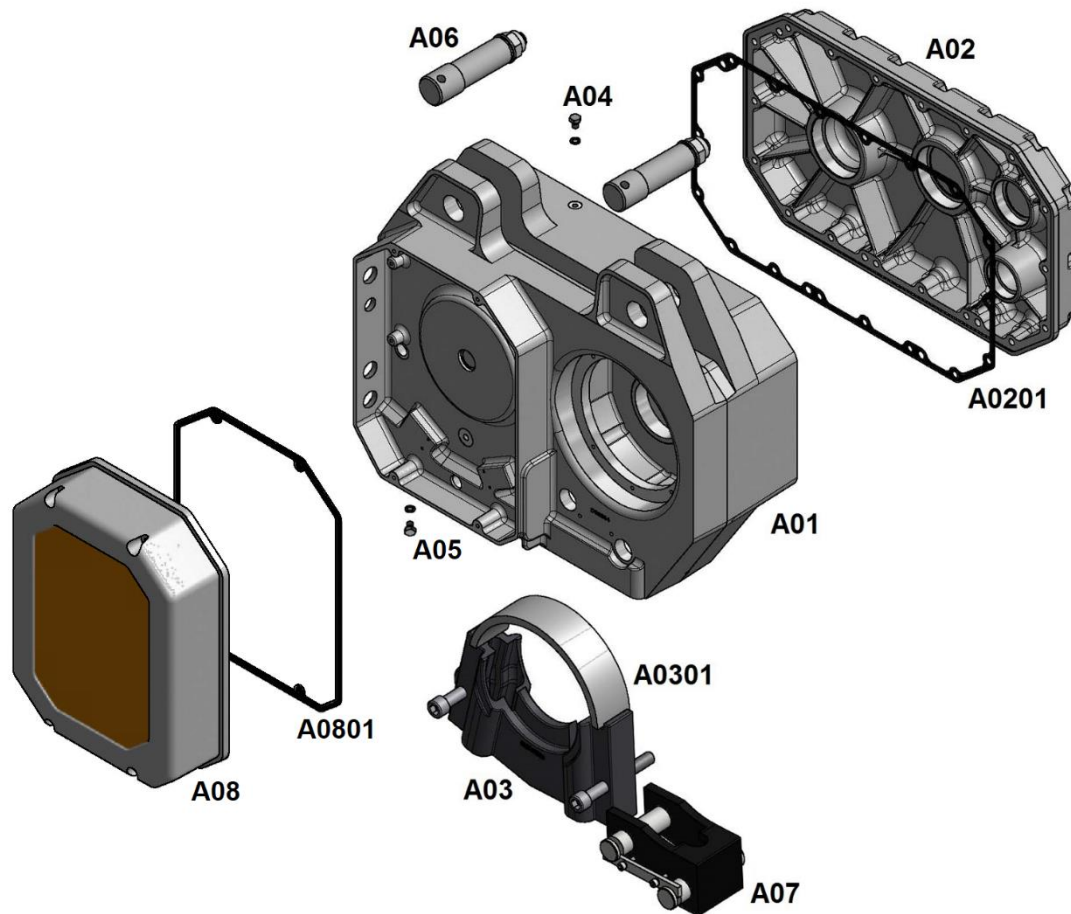

Code	Description	Version	Order number
A01	hoist body cpl.	B13/00X	01 9 00X 001/1
		B13/50X	01 9 50X 001/1
		B15/00Y	01 9 00Y 001/0
A02	gear cover cpl.		01 9 00X 002/1
A0201	gasket for gear cover		01 0 00X 039/0
A03	chain guide cpl.	B13/00X	01 9 00X 008/1
		B13/50X	01 9 50X 008/0
		B15/00Y	01 9 00Y 008/0
A0301	hold down	B13/00X, B15/00Y	01 0 00X 029/1
		B13/50X	01 0 50X 029/1
A04	oil filling screw cpl.		01 9 00A 200/0
A05	oil draining screw cpl.		01 9 00A 201/0
A06	set of bolts	B13/00X, B13/50X	01 9 00X 065/1
		B15/00Y	01 9 00Y 065/0
A07	chain suspension cpl.	B13/00X	01 9 00X 006/0
		B15/00Y	01 9 00Y 006/0
A08	cap for low voltage control cpl.		01 9 00X 005/0
A0801	gasket for cap low voltage control		01 0 00X 038/0

B Brake - clutch

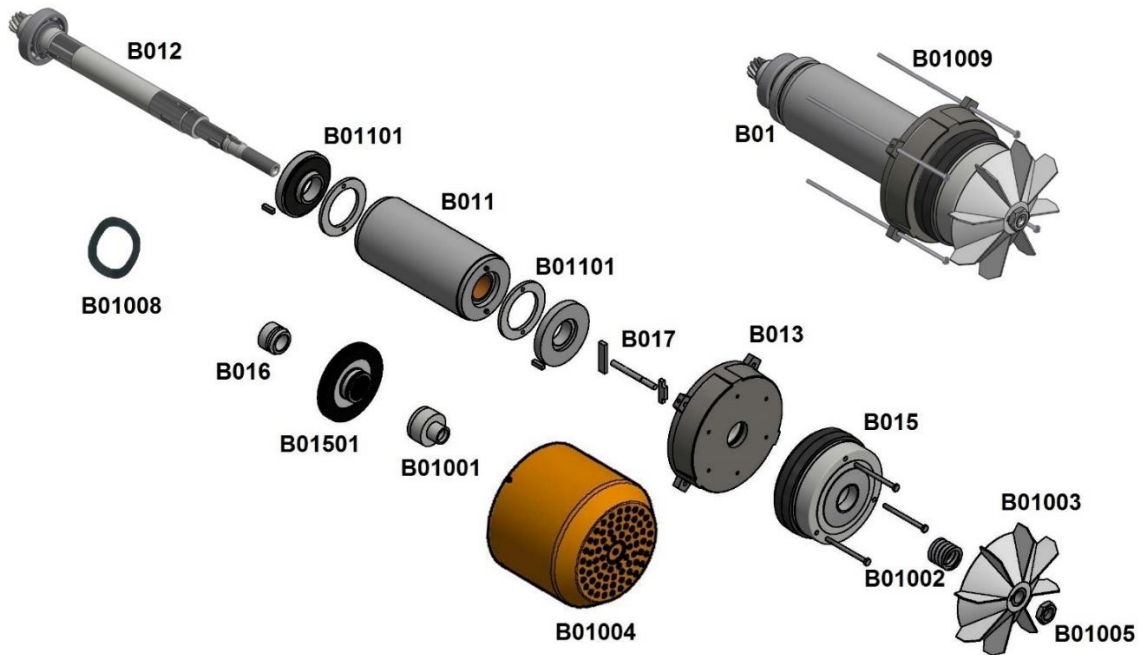

Code	Description	Version	Order number
B01	brake - clutch - section cpl.		01 2 00X42 400/0
B011	rotor cpl.		01 2 00X42 004/0
B01101	clutch hub cpl.		01 9 00X42 021/0
B012	motor pinion shaft		01 9 00X42 001/0
B013	bearing shield cpl.		01 9 00X42 220/0
B015	brake cpl.		01 9 00X42 200/0
B01501	brake disc		01 9 00X42 013/0
B016	distance bush cpl.		01 9 00X42 014/0
B01001	pressure bush *)		
B01002	pressure spring *)		
B017	pressure bolt cpl.		01 9 00X42 026/0
B01003	fan		55 6ZFB0 40001
B01004	cap for fan cpl.		01 9 00X42 221/0
B01005	counter nut		57 00936 20105
B01006	retrofit kit for manual release		55 6ZFB0 40003
B01007	cap for fan of manual release cpl.		01 9 00X42 221/0 HL
B01008	ball bearing compensating disc		70 0KGLG 79071
B01009	fastening screw		72 01768 06265

	B01002 – pressure spring *)		B01001 – pressure bush *)	
Normal load	Dimension	Order number	Order number	
7500 kg	5x32x51	23 00500 03200	01 0 00X42 023/0	
6300 kg	5x32x51	23 00500 03200	01 0 00X42 023/0	
5000 kg	5x32x51	23 00500 032V2A	01 0 00X42 023/0	
4000 kg	4,5x32,5x47	23 00405 03205	01 0 00X42 023/0	
3200 kg	4,5x36x53	23 00405 036V2A	01 0 00X42 058/0	
2500 kg	4,5x36x53	23 00405 036V2A	01 0 00X42 058/0	
1000 kg	5x32x51	23 00500 032V2A	01 0 00X42 023/0	

C Stator

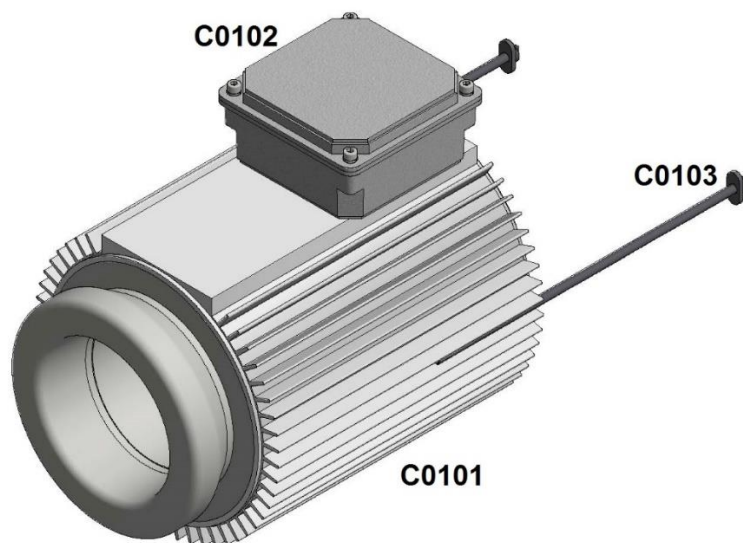

Code	Description	Version	Order number
C01	stator cpl.		01 9 00X42 008/0
C0101	motor body with stator		01 9 00X42 219/0
C0102	terminal box cpl.		01 9 00X42 039/0
C010201	mounting rail cpl.		11 9 00X42 500/0
C010202	set of terminal blocks		11 9 050 50 500/0
C010203	connecting cable	12x1,5 ² x 1,75 m	11 9 00X42 501/0
C010204	fastening element for cable cpl.		11 9 00X42 502/0
C0103	set of fastening screw cpl.		01 9 00X42 027/0

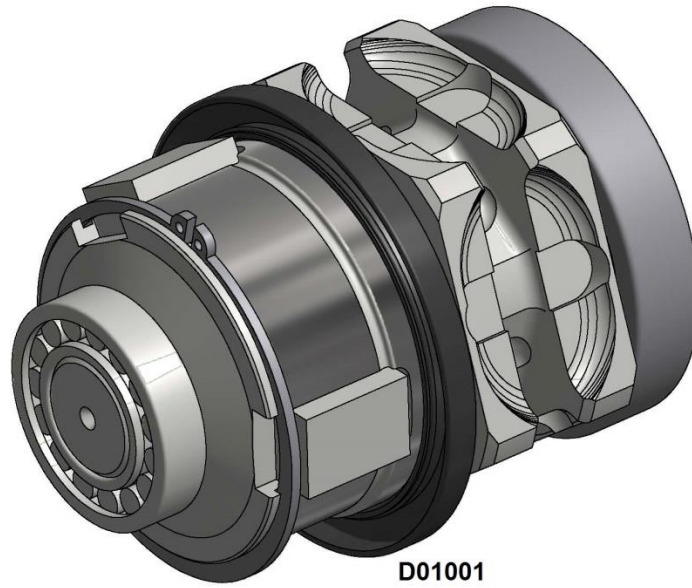
D Sprocket wheel

Code	Description	Version	Order number
D01	sprocket wheel cpl.	B13/00X	01 9 00X 026/2
		B13/50X	01 9 50X 026/0
		B15/00Y	01 9 00Y 026/0
D01001	shaft seal		64 10135 17012

E Chain

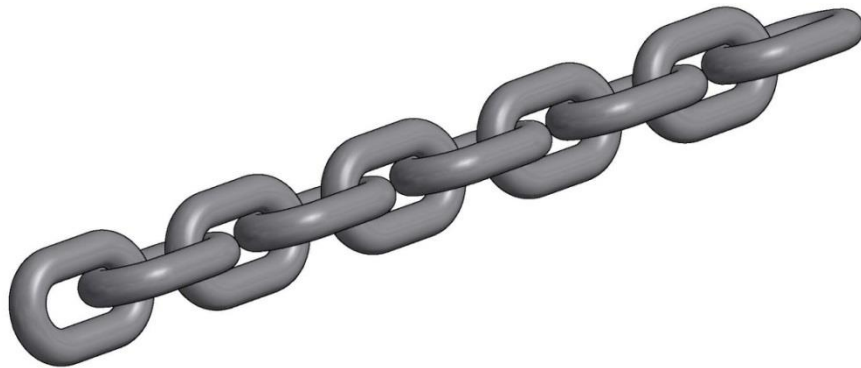

B13/00X

Code	Description	Version	Order number
E01	chain	16x45 mm	47 16045 00003V

B13/50X

Code	Description	Version	Order number
E01	chain	9x27 mm	47 09027 RT000V

B15/00Y

Code	Description	Version	Order number
E01	chain	17,3x48	47 17348 00002V

H Low voltage control

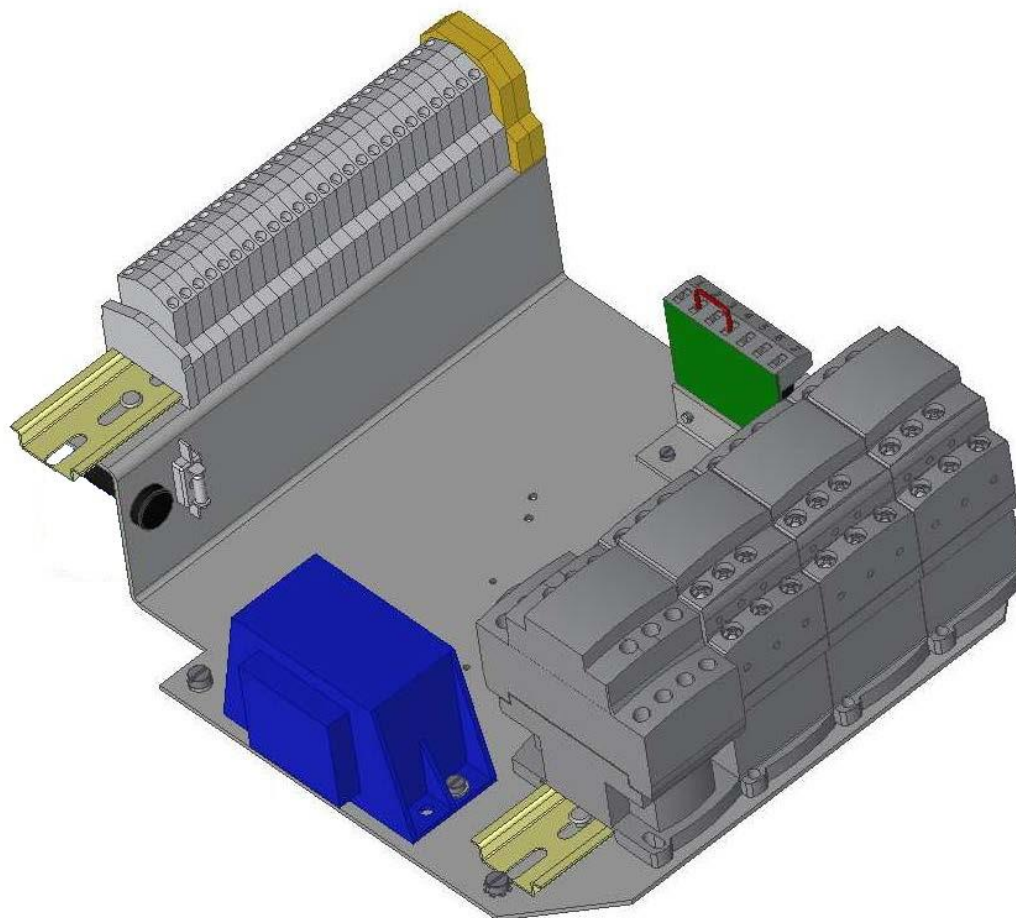







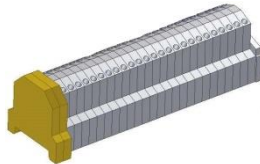
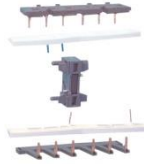
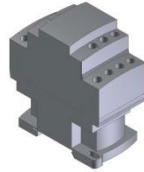











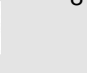

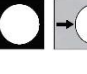
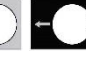
Code	Description	Version	Order number
H0101	low voltage control cpl. <u>with</u> emergency stop		11 9 00X 000/0
H0102	low voltage control cpl. <u>without</u> emergency stop		11 9 00X 000/0 O

Component



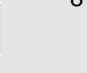

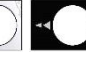
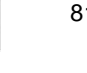







Code	Description	Version	Order number
H01001	rectifier		20 00040 00040F
H01002	contactor K1, K2, K3		74 3LC1D 18024
	contactor K4		74 3LC1D 12024
H01003	interlock K2, K3		74 3LA9D 09020
H01004	Transformer 230-400V/24V		88 00400 EI024
H01005	set of terminal blocks		11 9 00X 500/0
H01006	fuse holder primary		20 00060 00080
H01007	fuse holder secondary		20 00060 00081
H01008	micro fuse	1,25 A	20 00060 00082

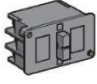





















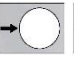

Control pendant complete

Code	Description	Symbol / Function	Order number
H02	control pendant	 	81 A0200 00000
		  	81 A0200 000NH
		   	81 A0201 00000
		    	81 A0201 000NH
		   	81 A0202 00000
		    	81 A0202 000NH

Control pendant / Component

Code	Description		Symbol / Function	Order number
H0202	contactor blocks			81 ZB2BE 00101
				81 ZB2BE 00201
				81 XEN0G 01191
				81 ZB2BE 00102
H0203	emergency stop button			81 ZA2BS 00834
H0204	rubber spare parts for button 1-step function		white	81 XAC0B 09111
			black	81 XAC0B 09112
	rubber spare parts for button 2-step function		white	81 XAC0B 09211
			black	81 XAC0B 09212

Control pendant / Control cable

Code	Description	Symbol / Function		Order number
H0201		 	5G1,5	45 0H070 05G15
		  	7G1,5	45 0YMH0 07G15
		   	7G1,5	45 0YMH0 07G15
		    	12G1,5	45 0H070 12G15
		   	12G1,5	45 0H070 12G15
		    	12G1,5	45 0H070 12G15

J Electric limit switch

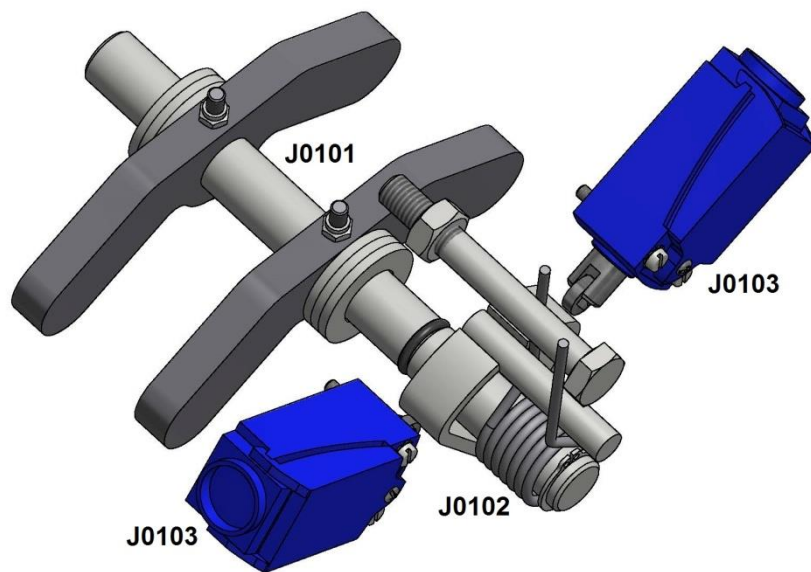

Code	Description	Version	Order number
J01	module electric limit switch cpl.	B13/00X, B15/00Y B13/50X	46 9 00X 000/0 46 9 50X 000/0
J0101	shaft for electric limit switches cpl.	B13/00X, B15/00Y B13/50X	01 9 00X 017/0 01 9 50X 017/0
J0102	leg spring		23 00002 18023
J0103	electric limit switch cpl.		01 9 00X 217/0

M Suspension eye

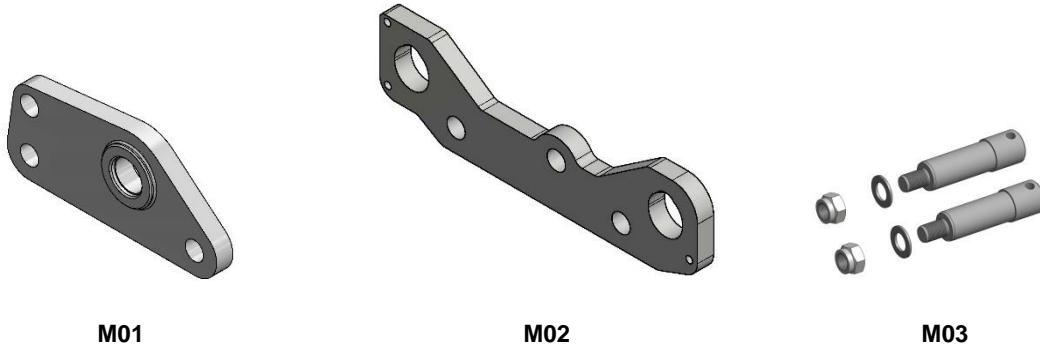

Code	Description	Version	Order number
M01	single hole suspension eye	B13/00X, B15/00Y	55 2 00X 002/0
M02	two bore holes suspension eye	B13/00X, B15/00Y	55 0 00X 001/0
		B13/50X	55 2 50X 001/0
M03	set of bolts	B13/00X, B13/50X	01 9 00X 065/1
		B15/00Y	01 9 00Y 065/0

N Hook suspension



N01



N0101

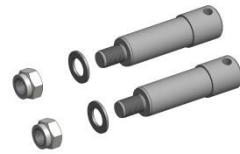

N02

Code	Description	Version	Order number
N01	hook suspension cpl.	B13/00X	56 2 00X 000/0
		B15/00Y	56 2 00Y 000/0
N0101	safety latch cpl.		30 00300 04001
N02	set of bolts cpl.	B13/00X, B13/50X	01 9 00X 065/1
		B15/00Y	01 9 00Y 065/0

O Hook block

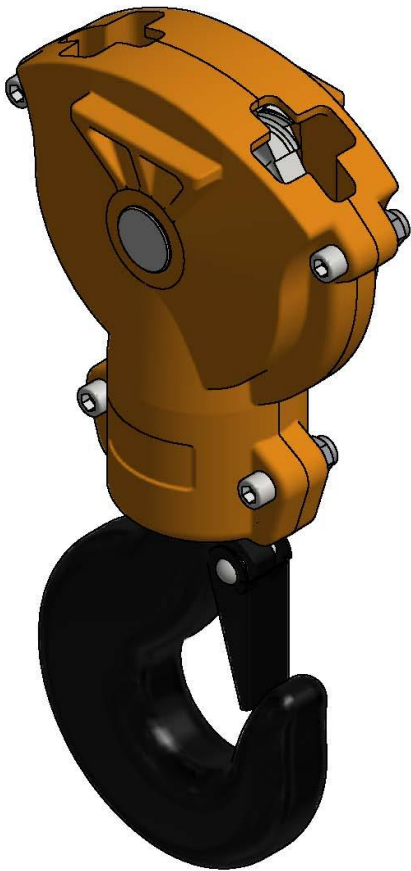

O01

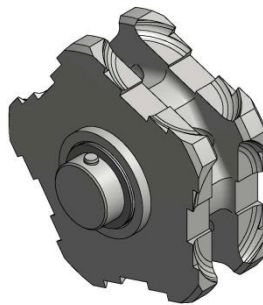

O0102



O0103

Code	Description	Version	Order number
O01	hook block cpl.	B13/00X B15/00Y	20 2 00X 000/1 20 2 00Y 000/0
O0102	sprocket wheel cpl.	B13/00X B15/00Y	20 9 00X 005/2 20 9 00Y 005/0
O0103	safety latch cpl.		30 00300 04001

P Hook tackle



P01



P0103



P02

Code	Description	Version	Order number
P01	hook tackle cpl.	B13/00X, B15/00Y	15 2 00X 000/0
		B13/50X	15 9 50X 000/0
P0103	safety latch cpl.	B13/00X, B15/00Y	30 00300 04001
		B13/50X	20 9 070 50 003/1
P02	spring actuator cpl.	B13/50X	53 2 50X 001/0

Q Lift limiter

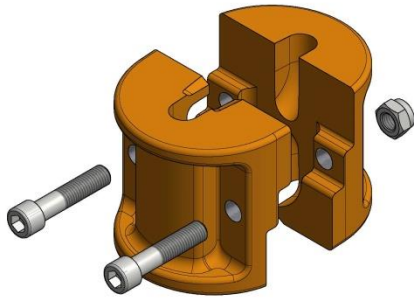

Q01

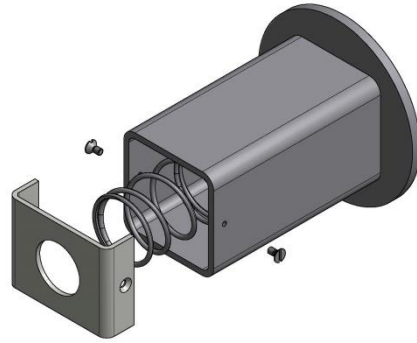

Q02

Code	Description	Version	Order number
Q01	lift limiter cpl.	B13/00X, B15/00Y	01 2 00X 010/0
		B13/50X	01 9 50X 010/0
Q02	spring actuator cpl.	B13/50X	53 2 50X 002/0

R Chain box

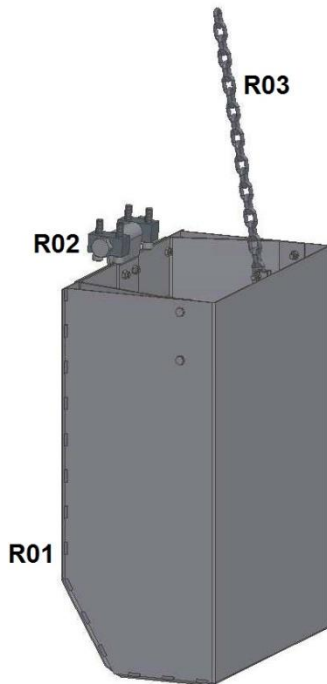

B13/00X

Code	Description	Chain/Meter	Order number
R01	chain box	16/10	29 2 10X 000/0
		16/16	29 2 20X 000/0
		16/25	29 2 30X 000/0
		16/40	29 2 40X 000/0
		16/50	29 2 50X 000/0
		16/63	29 2 60X 000/0
R02	suspension block cpl.		29 9 00X 009/0
R03	suspension chain cpl.		29 9 00X 011/0

B15/00Y

Code	Description	Chain/Meter	Order number
R01	chain box	17/8	29 2 10X 000/0
		17/10	29 2 20X 000/0
		17/16	29 2 30X 000/0
		17/25	29 2 40X 000/0
		17/40	29 2 50X 000/0
		17/50	29 2 60X 000/0
R02	suspension block cpl.		29 9 00X 009/0
R03	suspension chain cpl.		29 9 00X 011/0

V Electric trolley

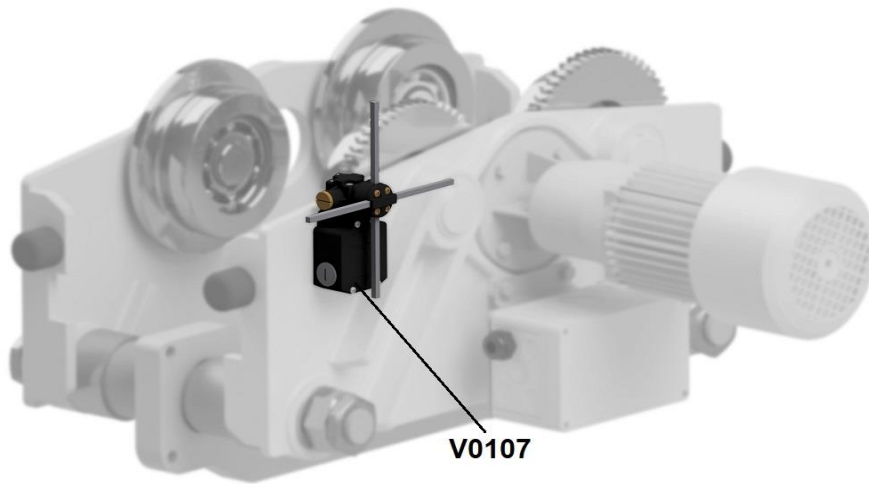
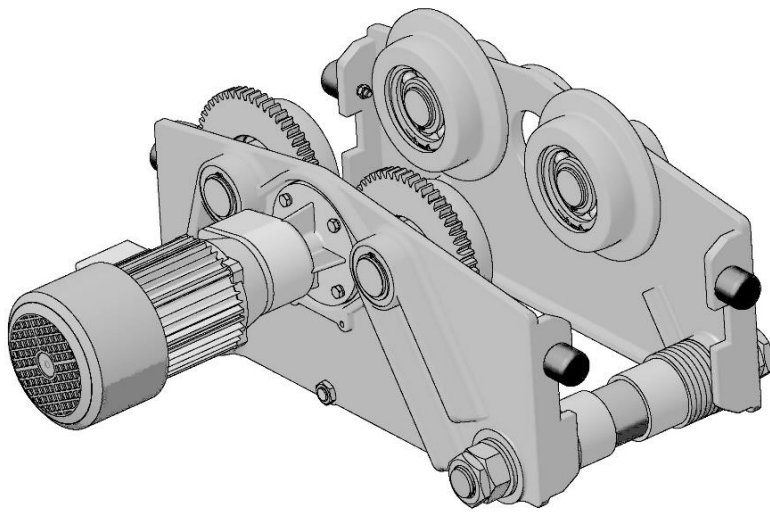

Component

Code	Description	Version	Order number
V01064	rectifier		20 00040 000E2
V0108	low voltage control		41 2 00X 000/0
V01081	contactor K5, K6		74 3LC2K 91024
V01082	contactor K7		74 3LC1K 98024
V01083	screwed cable gland	M20x1,5	50 00100 M2015G
V01084	counter nut	M20x1,5	50 00300 20002G
V01085	cable hoist → low voltage control	1,4 m	45 NYSLY 12010
V01086	cable low voltage control → motor	1,5 m	45 NYSLY 07015

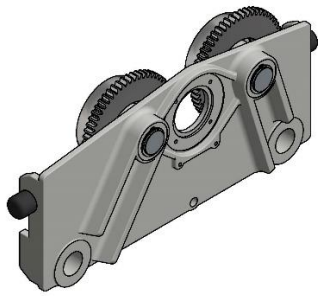

V0101

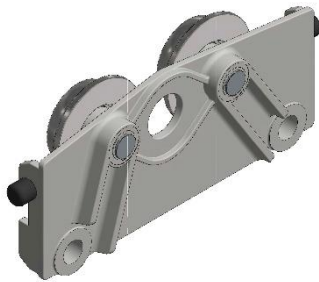

V0102



V0103



V0104

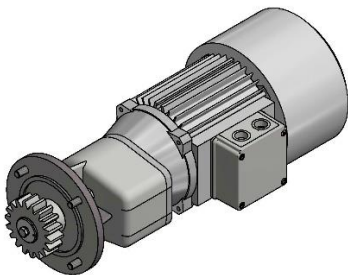

V0105



V01052



V01053

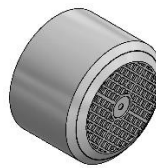

V01054



V01012

Code	Description	Version	Order number
V0101	motor side plate cpl.		39 9 00X 002/1
V01011	rod flange	N (140-230 mm)	39 9 00X 036/1
		S1 (220-310 mm)	39 9 00X 036.1/1
V01012	rubber buffer cpl.		39 9 00X 100/0
V0102	side plate cpl.		39 9 00X 001/1
V0103	wheel cpl.	geared	39 9 00X 011/0
		ungeared	39 9 00X 010/0
V0104	set of suspension bolts cpl.	N (140-230 mm)	39 9 00X 014/0
		S1 (220-310 mm)	39 9 00X 014.1/0
V0105	traveling motor cpl.	4+16 m/min	39 9 00X 221/1
V01052	pinion cpl.		39 9 00X 013/0
V01053	fan		55 6EFB2 00005
V01054	cap for fan		55 6EFB2 00006

W Tandem trolley

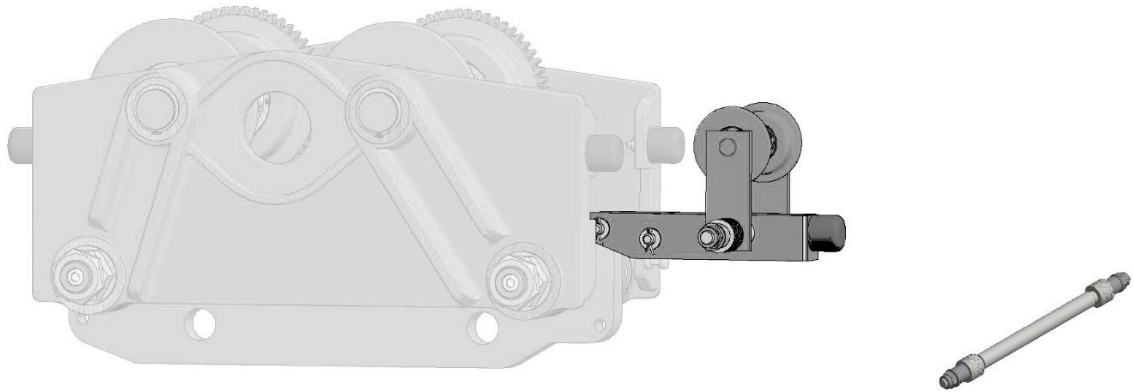

W01

W02

Code	Description	Version	Order number
W01	tandem trolley cpl.	N (140-230 mm)	31 2 00X 000/0
		S1 (220-310 mm)	31 2 01X 000/0
W02	suspension bolt cpl.	N (140-230 mm)	31 9 00D 012.1/0
		S1 (220-310 mm)	31 9 00D 012.2/0

