

# MECHANICAL JACKS

PJ Series - Planer Jacks

**SIMPLEX**



PJ1P, PJ2P, PJ3P & PJ4P Shown

**Sustaining Capacity** .....▶ **2 - 8 tons**

**Weight** .....▶ **15 - 12 lbs.**

**Operable Rise** .....▶ **1 - 4 in.**

- ▶ Side locking screw keeps the jack extended and prevents lowering due to vibration.
- ▶ Screw operation provides countless adjustments for exact leveling.
- ▶ Ideal jack for leveling plane beds, millers and machinery.
- ▶ Ball and socket cap swivels to center load forces.
- ▶ Notched base fastens easily to machine beds.

## THINK SAFETY



Please refer to pages 4&5 for a complete list of safety tips and recommendations.

## LOAD CAP



Slotted load cap prevents the load from possible slippage with inline applications.



## CE COMPLIANT

Our Jack design specifications meet or exceed ANSI /ASME B30.1 Safety Standards.

*The notched base and swivel socket cap makes the versatile Planer Jack the perfect choice for repair & maintenance. ▼*

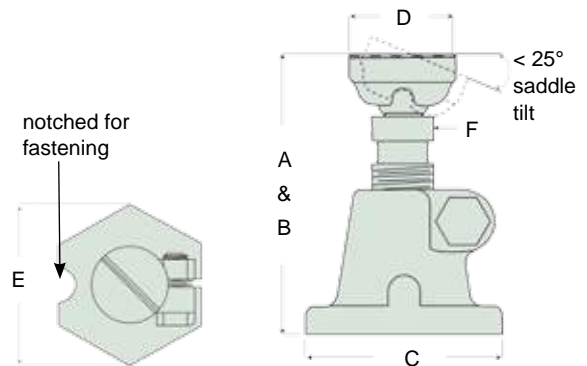

Model	Sustaining Capacity (tons)	Operable Rise (in)	Dimensions (in)						Weight (lbs)
			A	B	C	D	E	F	
			Minimum Height	Maximum Height	Across Flats	Cap Diameter	Across Points	Hex Across Flats	
PJ1P	2	1	2.75	3.75	2.38	1.25	2.75	.75	1.5
PJ2P	4	1.5	3.75	5.25	3.13	1.68	3.62	1	3
PJ3P	6	2.25	5.25	7.5	4	2.06	4.62	1.25	6
PJ4P	8	4	7.5	11.5	5.38	2.5	6.19	1.5	12

Mechanical Jacks